

## Connecteurs pour assemblages bois

BAT Maxi speedy

BAT Maxi speedy

ART NR	1 Lengte Longueur mm	2 Breedte Largeur mm	3 Hoogte Hauteur mm	Voor balk Pour poutre	* 	
B50402	240	38	101	ongeschaafd - brut 6/4 10	box	30
BR504.240038.01	240	38	101	ongeschaafd - brut 6/4 10	riptom box	30
B50412	335	38	149	ongeschaafd - brut 6/4 15	box	30
BR504.335038.01	335	38	149	ongeschaafd - brut 6/4 15	riptom box	30
B50413	380	38	171	ongeschaafd - brut 6/4 18	box	30
BR504.380038.01	380	38	171	ongeschaafd - brut 6/4 18	riptom box	30
B50404	240	46	97	geschaafd - raboté 5/13	box	30
BR504.240046.01	240	46	97	geschaafd - raboté 5/13	riptom box	30
B50452	335	46	145		box	30
B50406	240	50	95	ongeschaafd - brut 5/13	box	30
BR504.240050.01	240	50	95	ongeschaafd - brut 5/13	riptom box	30
B50414	335	50	143		box	30
BR504.335050.01	335	50	143		riptom box	30
B50416	335	59	138	geschaafd - raboté 7/15	box	30
BR504.335059.01	335	59	138	geschaafd - raboté 7/15	riptom box	30
B50420	380	59	161	geschaafd - raboté 7/18	box	30
B50410	240	63	89		box	30
BR504.240063.01	240	63	89		riptom box	30
B50418	335	63	136	ongeschaafd - brut 7/15	box	30
BR504.335063.01	335	63	136	ongeschaafd - brut 7/15	riptom box	30
B50422	380	63	159	ongeschaafd - brut 7/18	box	30
BR504.380063.01	380	63	159	ongeschaafd - brut 7/18	riptom box	30
B50423	440	63	189		box	30
B50424	440	71	185	geschaafd - brut 8/23	box	20
BR504.440071.01	440	71	185	geschaafd - brut 8/23	riptom box	30
B50458	380	75	153		box	30
BR504.380075.01	380	75	153		riptom box	30
B50426	440	75	183	ongeschaafd - brut 8/23	box	20
BR504.440075.01	440	75	183	ongeschaafd - brut 8/23	riptom box	30
B50436	500	100	200		box	30
B50438	560	100	230		box	30
BR504.560100.01	560	100	230		riptom box	30
B50440	620	100	260		box	20

Bevestiging op draagbalk: gebruik hiervoor de nagels art B85505

Zijdelingse bevestiging: gebruik hiervoor nagels Art B85501

\* Box: kartonnen doos - boîte en carton

Riptombox: doos met afscheurdeksel - boîte à couvercle déchirable

Fixation sur poutre portante: utilisez clous art B85505

Fixation latérale: utilisez les clous Art B85501

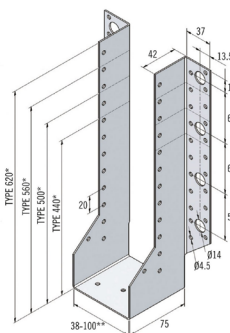
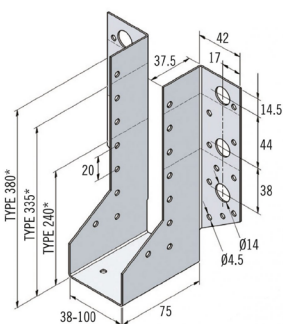
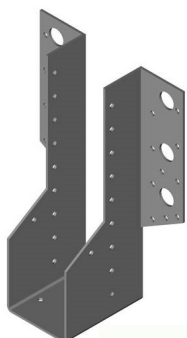

## KEUZE VAN DE BAT MAXI SPEEDY / CHOIX DU BAT MAXI SPEEDY

### TOEPASSINGEN

Voor zware hout op hout constructies.  
 Voor zware balken tussen spanten en muren.  
 Voor gordingen tussen betonwanden.  
 Voor het verankeren en verstevigen van houtconstructies.

### MATERIAAL

15 mm pre-galvaniseerd staal DX51D + Z275 volgens BS EN 10327:2004.  
 Europese technische goedkeuring : ETAG 15 - BS EN 845-1

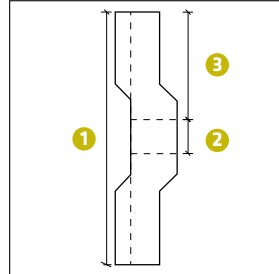

### APPLICATION

Pour bois lourd sur construction bois.  
 Pour poutres lourdes entre murs.  
 Pour faitage entre murs béton.  
 Pour ancrage de construction bois

### MATIÈRE

15 mm Acier pre-galvanisé DX51D + Z275 suivant BS EN 10327:2004.  
 Agrément Technique Européen : ETAG 15 - BS EN 845-1

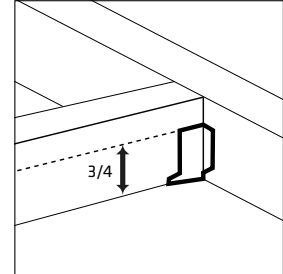
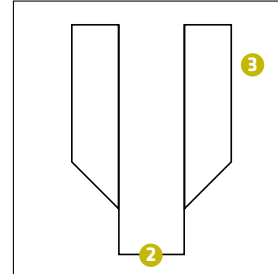

### HOUTVERBINDER KIEZEN

Kant moet 3/4-de bedekken (hoogte van de verbinder) **3**  
 Onderkant van de balk (breedte van de Maxi Speedy) **2**  
 Voorbeeld:

- 7/18 (ongeschaafd) = Maxi Speedy 63 159
- 7/15 (ongeschaafd) = Maxi Speedy 63 136

### CHOISIR SON CONNECTEUR

Flanc doit couvrir 3/4 (hauteur du connecteur) **3**  
 Dessous de la poutre (largeur du Maxi Speedy) **2**  
 Exemple:

- 7/18 (non-raboté) = Maxi Speedy 63 159
- 7/15 (non-raboté) = Maxi Speedy 63 136

## MAXI SPEEDY TOELAATBARE BELASTING / CHARGE ADMISSIBLE (KN) - (1KN ± 100KG)

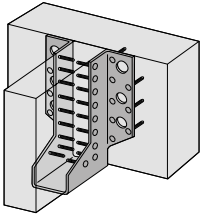

NAILS ONLY		
Type	No of Nails into Face	kN
240	12	3,9
335	18	5,9
380	20	6,5
440	26	9,2
500	32	10,5
560	38	11,2
620	44	13,0

3,75x30mm long square twisted sherardised

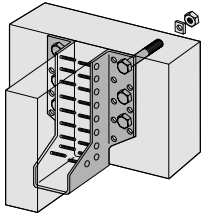

BOLTS ONLY		
Type	No of Nails into Face	kN
240	2	3,6
335	4	6,9
380	6	10,1
440	4	6,9
500	6	10,1
560	6	10,1
620	8	13,0

M12 Bolts

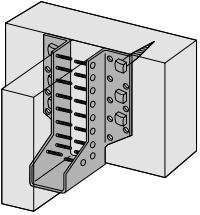

COACH SCREWS		
Type	No of Nails into Face	kN
240	2	3,0
335	4	5,9
380	6	8,6
440	4	5,9
500	6	8,6
560	6	8,6
620	8	11,1

12mm 0x63mm long (min) USING STARTERS HOLES

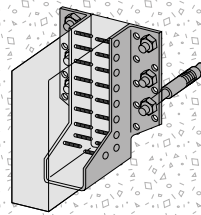



MASONRY ANCHORS						
Bolt Size	No of Nails into Face	SWL's for Masonry Strengths of				
		20N	15N	7N	3,5N	2,8N
12mm	2	7,2kN	5,4kN	2,5kN	1,2kN	1kN
12mm	4	14,4kN	10,5kN	5,0kN	2,5kN	2kN
12mm	6	21,0kN	15,5kN	7,5kN	3,7kN	3kN

Indicative loads: refer to fixings supplier for recommended loads

# Nagels

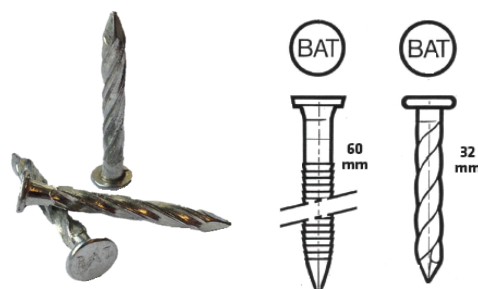

## Clous

ART NR	Ø x L mm	verpakking		
B85501Z	3,8x32	zak/sachet	100	2500
B85501K	3,8x32	box	1kg (+/- 400st)	
B85501	3,8x32	box	1000	8000
B85505Z	3,8x60	zak/sachet	75	1875
B85505K	3,8x60	box	1kg (+/- 200st)	12 x 1kg
B85505	3,8x60	box	1000	4000



# Minispeedy

## Minispeedy

ART NR	BREEDTE LARGEUR mm	HOOGTE HAUTEUR mm		
B52501	25	75	box	125
BR525.000025.01	25	75	riptop box	100
B52502	32	70	box	125
BR525.000032.01	32	70	riptop box	100
B52503	38	70	box	125
BR525.000038.01	38	70	riptop box	100
B52504	46	65	box	125
BR525.000046.01	46	65	riptop box	100
B52505	50	65	box	125
BR525.000050.01	50	65	riptop box	100
B52506	59	60	box	125
B52507	63	60	box	125
BR525.000063.01	63	60	riptop box	100

Toepassing:  
voor lichtere balken, belasting 1,6 kN

Materiaal:  
0,9mm pre galvanised staal DX51D +  
Z275 volgens BS EN 10327-2004

Bevestiging:  
Nagels 3,8x32mm

Application:  
pour poutres légères, charges 1,6 kN

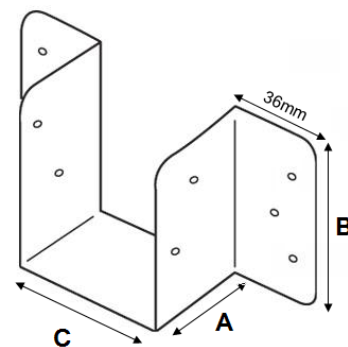
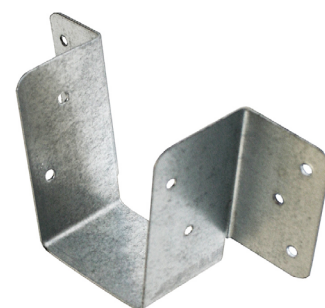

Matière:  
0,9mm pre galvanised acier DX51D +  
Z275 selon BS EN 10327-2004

Fixation:  
Clous 3,8 x 32mm



## Hoekankers zonder versteviging

### Equerres sans renfort

ART NR	LENGTE LONGUEUR mm	BREEDTE LARGEUR mm	HOOGTE HAUTEUR mm		
B53401	125	46	125	box	50
BR534.046250.01	125	46	125	riktop box	50
B53402	125	55	125	box	50
BR534.055250.01	125	55	125	riktop box	50
B53403	60	60	40	box	100
BR534.060100.01	60	60	40	riktop box	100
B53404	90	59	90	box	50
BR534.063180.01	90	59	90	riktop box	50
B53405	50	35	50	box	100
BR534.035100.01	50	35	50	riktop box	100
B53406	150	63	150	box	50
BR534.063300.01	150	63	150	riktop box	50
B53407	150	59	90	box	50
BR534.063240.01	150	59	90	riktop box	50
B53408	90	59	60	box	50

#### Toepassing:

Voor houtverbindingen en stellen van kozijnen

Belasting: 0,6kN per nagel

#### Materiaal:

2mm pre galvanised staal DX51D + Z275 volgens BS EN 10327-2004

Bevestiging: Bout/houtdraadbout of Nagels 3,8mm

#### Application:

Connexion bois

Charge: 0,6kN par clou

#### Matière:

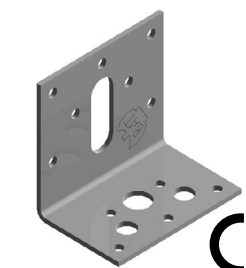
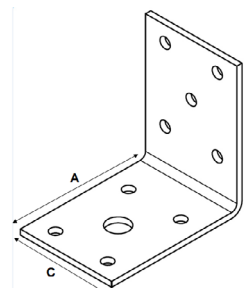
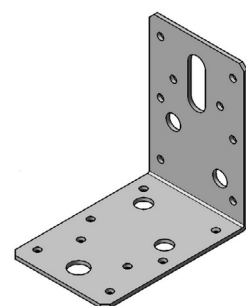

2mm pre galvanised acier DX51D + Z275 selon BS EN 10327-2004

Fixation: Boulon/tirefond ou clous 3,8mm



## Hoekankers met versteviging

### Equerres avec renfort

ART NR	LENGTE LONGUEUR mm	BREEDTE LARGEUR mm	HOOGTE HAUTEUR mm		
B53501	125	46	125	box	50
BR535.046250.01	125	46	125	riktop box	50
B53502	125	55	125	box	50
BR535.055250.01	125	55	125	riktop box	50
B53503	90	59	90	box	50
BR535.063180.01	90	59	90	riktop box	50
B53505	150	63	150	box	40
BR535.063300.01	150	63	150	riktop box	40
B53506	80	70	50	box	50
BR535.070132.01	80	70	50	riktop box	50
B53507	150	59	90	box	50
BR535.063240.01	150	63	90	riktop box	50
B53508	90	50	60	box	50

#### Toepassing:

Voor houtverbindingen en stellen van kozijnen.

Belasting Draagkracht 0,5kN en Afschuifkracht 0,9kN per nagel

#### Materiaal:

2mm pre galvanised staal DX51D + Z275 volgens BS EN 10327-2004

Bevestiging: Bout/houtdraadbout of Nagels 3,8mm

#### Application:

Connexion bois.

Charge portante 0,6kN et arrachement 0,9kN par clou

#### Matière:

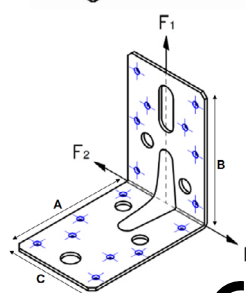
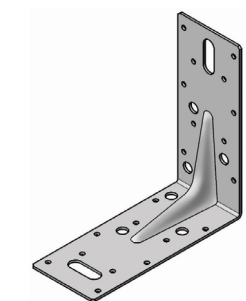

2mm pre galvanised acier DX51D + Z275 selon BS EN 10327-2004

Fixation: Boulon/tirefond ou clous 3,8mm



## U-Nail

## U-Nail

ART NR	LENGTE LONGUEUR mm	BREEDTE LARGEUR mm		
B50801	51	76	box	100
B50802	100	76	box	100
BR508.076100.01	100	76	riptop box	100
B50803	152	76	box	100
B50804	203	76	box	100
B50805	254	76	box	100
B50808	100	114	box	100
B50809	152	114	box	100
BR508.114152.01	152	114	riptop box	100
B50810	203	114	box	100
BR508.114203.01	203	114	riptop box	100
B50811	254	114	box	50
BR508.114254.01	254	114	riptop box	50
B50812	305	114	box	25
B50813	51	152	box	100
B50814	100	152	box	200
B50815	152	152	box	75
B50816	203	152	box	50
B50817	254	152	box	100
BR508.152254.01	254	152	riptop box	50
B50818	305	152	box	25
BR508.152305.01	305	152	riptop box	50

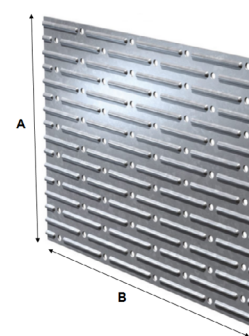
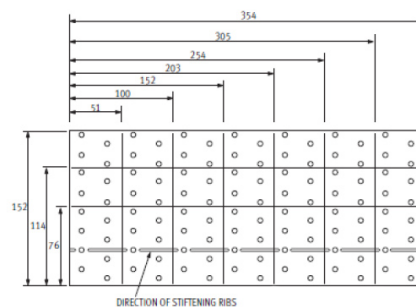
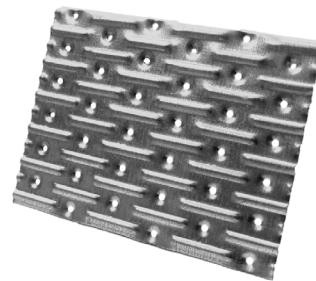

### Toepassing:

Voor verbindingen van palen, balken en herstellingen  
belasting 0,5kN per nagel

### Materiaal:

1,25mm pre galvanised staal DX51D + Z275 volgens BS EN 10327-2004

### Bevestiging:

Nagels 3,8x32mm

### Application:

Pour liaison poteau, poutre, assemblage et réparations.  
Charge 0,5kN par clou

### Matière:

1,25mm pre galvanised acier DX51D + Z275 selon BS EN 10327-2004

### Fixation:

Clous 3,8 x 32mm

## Speedy

## Speedy

ART NR	B2	B1	C	A
B50602	190	115	32	50
B50604	190	115	38	50
B50608	190	115	50	50
B50612	225	150	38	50
B50616	225	150	50	50
B50620	225	150	63	50

### Toepassing:

Voor raveelconstructies en gordingen tussen spanen

### Materiaal:

1,5mm pre galvanised staal DX51D + Z275 volgens BS EN 10327-2004

### Bevestiging:

Nagels 3,8x32mm

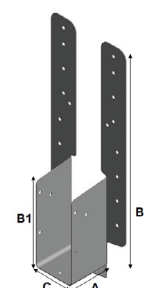

### Application:

Pour pose de solives et mardiers

### Matière:



1,5mm pre galvanised acier DX51D + Z275 selon BS EN 10327-2004

### Fixation:

Clous 3,8 x 32mm

## Koppelplaat

## Plaque de liaison

ART NR	LENGTE LONGUEUR mm	BREEDTE LARGEUR mm		
B53301	250	46	box	50
B53302	250	55	box	100
BR533.055250.01	250	55	riptop box	50
B53303	175	59	box	50
BR533.063180.01	175	59	riptop box	50
B53304	235	59	box	50
BR533.063240.01	235	59	riptop box	50
B53305	300	63	box	50
BR533.063300.01	300	63	riptop box	50

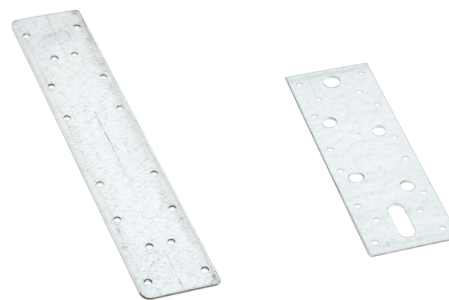

### Toepassing:

Voor het koppelen van balklagen

### Application:

Pour la connexion de poutres

### Materiaal:

2mm pre galvanised staal DX51D + Z275 volgens BS EN 10327-2004

### Matière:

2mm pre galvanised acier DX51D + Z275 selon BS EN 10327-2004

### Bevestiging:



Nagels 3,8x32mm of bouten 9 en 11mm

### Fixation:

Clous 3,8x32mm ou ancrés 9 et 11mm

## Timbernails

## Timbernails

ART NR	LENGTE LONGUEUR mm	BREEDTE LARGEUR mm		
B53703	102	25	box	1200
B53703V	102	25	box	100
B53705	127	25	box	900
B53705V	127	25	box	100



### Toepassing:

vervaardigen van houten spanten

### Application:

assemblage de poutres

### Materiaal:

1mm pre galvanised staal DX51D + Z275 volgens BS EN 10327-2004

### Matière:

1mm pre galvanised acier DX51D + Z275 selon BS EN 10327-2004

### Bevestiging:

kleine afmetingen met hamer, grotere met hydraulische pers (op aanvraag)

### Bevestiging:



petites dimension avec marteau, grandes avec presse hydraulique (sur demande)

Andere afmetingen op aanvraag

Autres dimensions sur demande

## Multigrip

### Multigrip

ART NR	BREEDTE LARGEUR mm	HOOGTE HAUTEUR mm		
B5101	34	127	box	200



**Toepassing:**  
stevige verankering en verbinding van balken. Belasting 3,7kN per paar in lengtebelasting

**Application:**  
fixation solide de poutres. Charge 3,7kN en charge dans la longueur

**Materiaal:**  
1mm pre galvanised staal DX51D + Z275 volgens BS EN 10327-2004



**Matière:**  
1mm pre galvanised acier DX51D + Z275 selon BS EN 10327-2004

**Bevestiging:**  
Nagels 3,8x32mm

**Bevestiging:**  
Clous 3,8x32mm

## Ruiterklos

### Chantignol

ART NR	BREEDTE LARGEUR mm		
B52801	32	box	25



**Toepassing:**  
bevestiging van ruiter op dakplaat, dakhelling 35°

**Application:**  
Support de faitage avec inclinaison de toit 35°

**Materiaal:**  
2mm pre galvanised staal DX51D + Z275 volgens BS EN 10327-2004



**Matière:**  
2mm pre galvanised acier DX51D + Z275 selon BS EN 10327-2004

**Bevestiging:**  
Nagels 3,8x32mm

**Bevestiging:**  
Clous 3,8x32mm

## Versterkingshoek



### Equerre

ART NR	BREEDTE LARGEUR mm	HOOGTE HAUTEUR mm		
JW052004B04	30	30	box	10x4st/pc
JW052006B04	40	40	box	10x4st/pc
JW052010B04	60	60	box	10x4st/pc



## Stoelhoek



### Equerre

ART NR	LENGTE LONGUEUR mm		
JW050631B04	25	box	10x4st/pc
JW050632B04	40	box	10x4st/pc
JW050633B04	55	box	10x4st/pc
JW050634B04	70	box	10x4st/pc
JW050635B04	85	box	10x4st/pc
JW050636B04	100	box	10x4st/pc



## Raamhoek



### Equerre plate

ART NR	LENGTE LONGUEUR mm	BREEDTE LARGEUR mm		
JW050331B01	40	10	box	200
JW050333B01	60	10	box	100
JW050334B01	70	14	box	100
JW050335B01	80	17	box	100
JW050336B01	100	18	box	100



## Drempelhoek zwaar



### Equerre lourde

ART NR	LENGTE LONGUEUR mm	BREEDTE LARGEUR mm		
JW050690B01	100	20	box	10
JW050691B01	125	20	box	10
JW050692B01	150	25	box	10
JW050699B01	175	25	box	10
JW050693B01	200	25	box	10
JW050694B01	250	30	box	10



## Verbindingsplaat

### Plaque de liaison

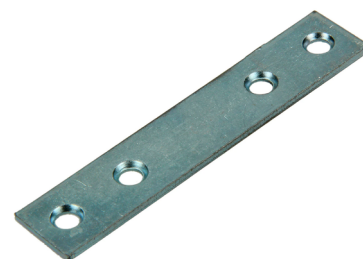

ART NR	LENGTE LONGUEUR mm	BREEDTE LARGEUR mm		
JW050681B01	50	15	box	100
JW050682B01	80	15	box	100
JW050683B01	110	15	box	100
JW050684B01	140	20	box	100





## Zware plankdrager



### Equerre de console renforcée

ART NR	LENGTE LONGUEUR mm	BREEDTE LARGEUR mm		
JW082130B01	210	295	box	10
JW082135B01	270	395	box	10
JW082140B01	330	495	box	10



## Kroonlijsthaak

### Equerre de corniche

ART NR	LENGTE LONGUEUR mm	BREEDTE LARGEUR mm	HOOGTE HAUTEUR mm		
JW050320B01	80	150	90°	box	10
JW050321B01	110	150	90°	box	10
JW050322B01	80	150	120°	box	10
JW050323B01	110	150	120°	box	10



## Bandijzer geperforeerd op rol

### Feuillard perforé sur rouleau

ART NR	LENGTE LONGUEUR m	BREEDTE LARGEUR mm	
BY251010	10	25	10
BY251025	25	25	5



## Bandijzer geperforeerd in afrolverpakking

### Feuillard perforé en dévidoir

ART NR	LENGTE LONGUEUR m	BREEDTE LARGEUR mm	
BY1208	10	12	10
BY1708	10	17	10



## Bandijzer geperforeerd geplastificeerd in afrolverpakking

### Feuillard perforé plastifié en dévidoir

ART NR	LENGTE LONGUEUR m	BREEDTE LARGEUR mm	
BY2610	10	26	1
BYG1930	10	19	1

